

Fixing instructions

STENI Colour, STENI Vision and STENI Nature

The facade panels are fixed as ventilated cladding on impregnated, wooden battens.

Product information on pallet

The panels must be stored on pallets in a dry place, under cover and on firm level ground.

Documents, product information and fixing instructions are attached to the pallet.

STENI Colour and STENI Vision can be delivered in 3 different gloss levels. The pallet will be marked with the type of gloss level.

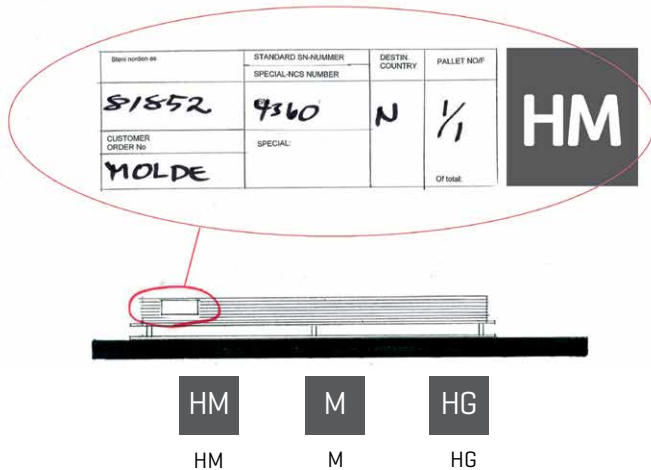

FS100

Smooth fixing of facade panels on wooden battens

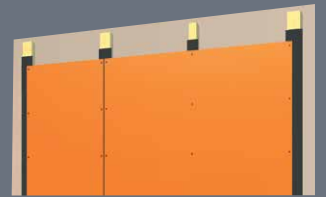

Special documentation

Reaction to fire:

EN 13501-1, B-s1,d0

STENI reserves the right to make changes/additions to the fixing instructions without further notice.

Control of measurements and tolerances

Make sure to control the measurements of the wall and panels before fixing. The panels have a tolerance of ± 2 mm, on width and length. Edge straightness of ± 1 mm, and a diagonal tolerance of max 3 mm.

Minor differences in measurements should be spread over several panels to achieve nice and even gaps between the panels.

Tolerance of drilling: ± 5 mm.

Handling of panels

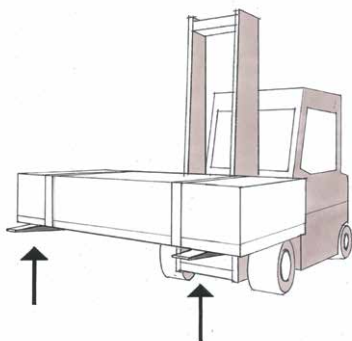

When transported on building site the pallets must always be strapped.

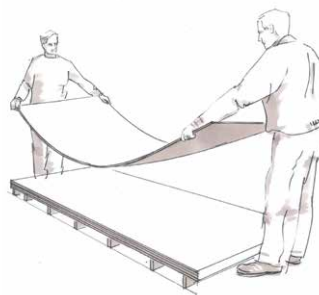

Lift the panels straight up from the pallets to avoid scratches.

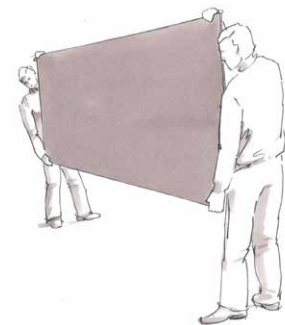

Carry the panels vertically.

Wooden battens

The fixing of STENI facade panels are done as ventilated cladding on impregnated, wooden battens in accordance with Nordic standard AB [NS-INSTA 141]. Minimum quality C18 [18-20% RF]. It is important that the battens are levelled vertically and horizontally to ensure the best result.

Standard batten dimensions: [max dimension batten: 28 mm]

Underneath panel joint: 23 x 73 mm

Underneath centre of panel: 23 x 48 mm

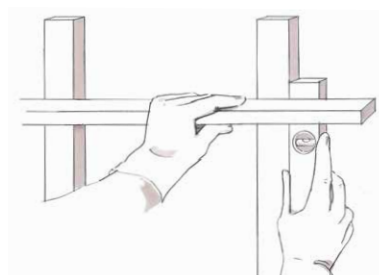

Fixing of STENI Nature

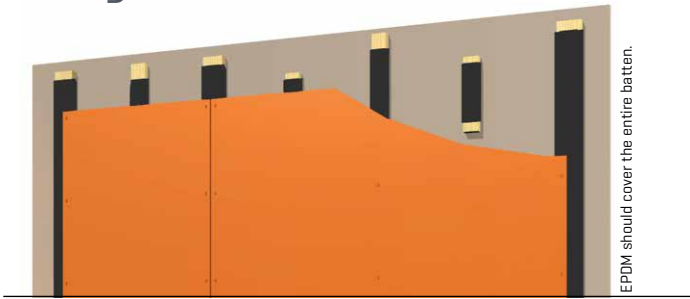

When fixing STENI Nature use an extra batten [c/c300] underneath all horizontal joints. Use at least one short batten, [see ill.], or use one whole batten. Half format (595 mm width) needs a full length batten as midsupport.

Horizontal cross sections - vertical fixing:

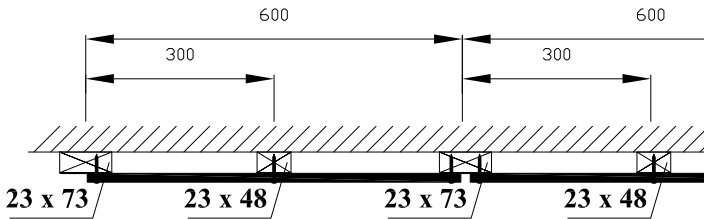

Fixing advice

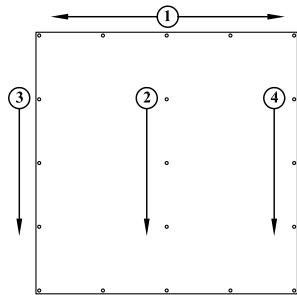

Distance tool
When fixing with joint profile it is wise to use a distance tool.

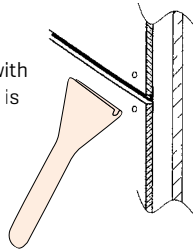

Screw pattern

Use a measuring tool to set reference lines vertically and horizontally before starting the fixing of panels. The illustration shows a sample of screw pattern.

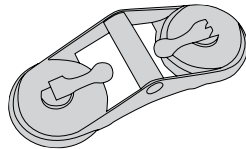

"Vacuum tool for glass"
This makes handling of STENI panels easier.

Cutting and drilling

STENI Colour and STENI Vision is cut on the front side. Use straight edge. [Cutting disc 1]. Speed: min. 3000 r/min. STENI Nature is cut from the back side. [Cutting disc 2]. Drilling is done with a drill for tiles. Diameter of panel holes: 5,5 mm for STENI standard screw.

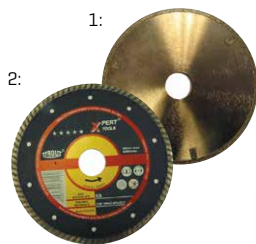
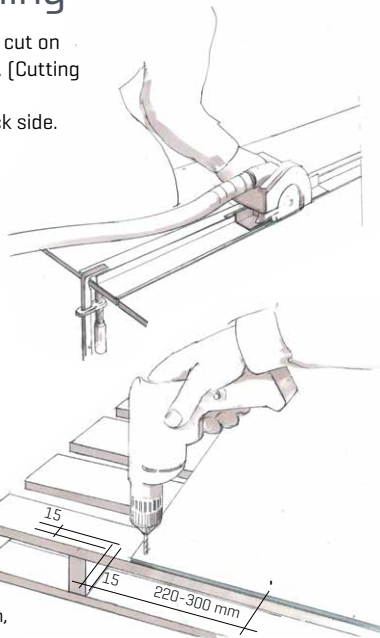

NB! Use protective equipment! See our documentation about health, environment and safety.

Fixing with open joint



Open joints:
Normally the panels are fixed with a 5 mm open joint, vertically and horizontally.

Fixing with joint profiles

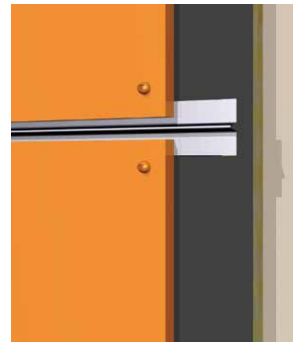

When using joint profiles use a distance of 8-10 mm. The panels must never be fixed edge-to-edge. Remember to fix the profiles with at least 5 mm open joints between each length.

1. Vertical profil: FP 6-30
2. Horizontal profil: HFP 7-30
3. Horizontal profil: HP 7-30

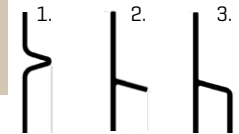

Fixing with corner or u-element

Corner element:

As corner solutions we recommend to use corner or corner profiles in order to ensure straight and nice solutions.

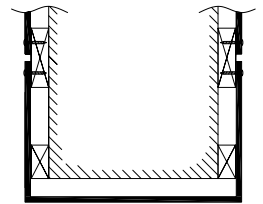
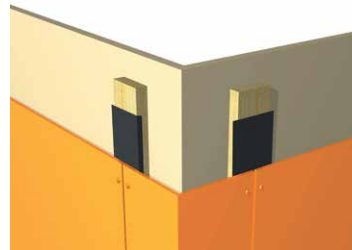

Outside corner with u-element.

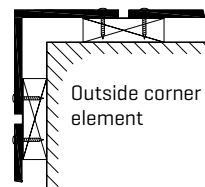

Outside corner element

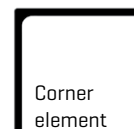

Corner element

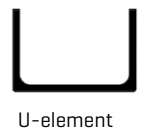

U-element

Fixing with corner profile

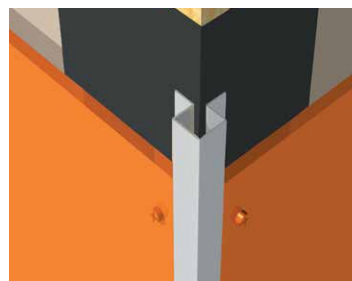

Remember to fix the profiles with at least 5 mm open joints between each length.



CP 15-13

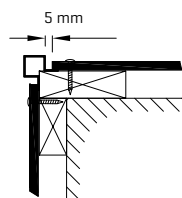

Corner with corner profile

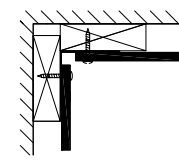

Inside corner

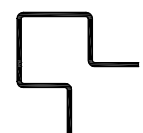

CP 15-18-33

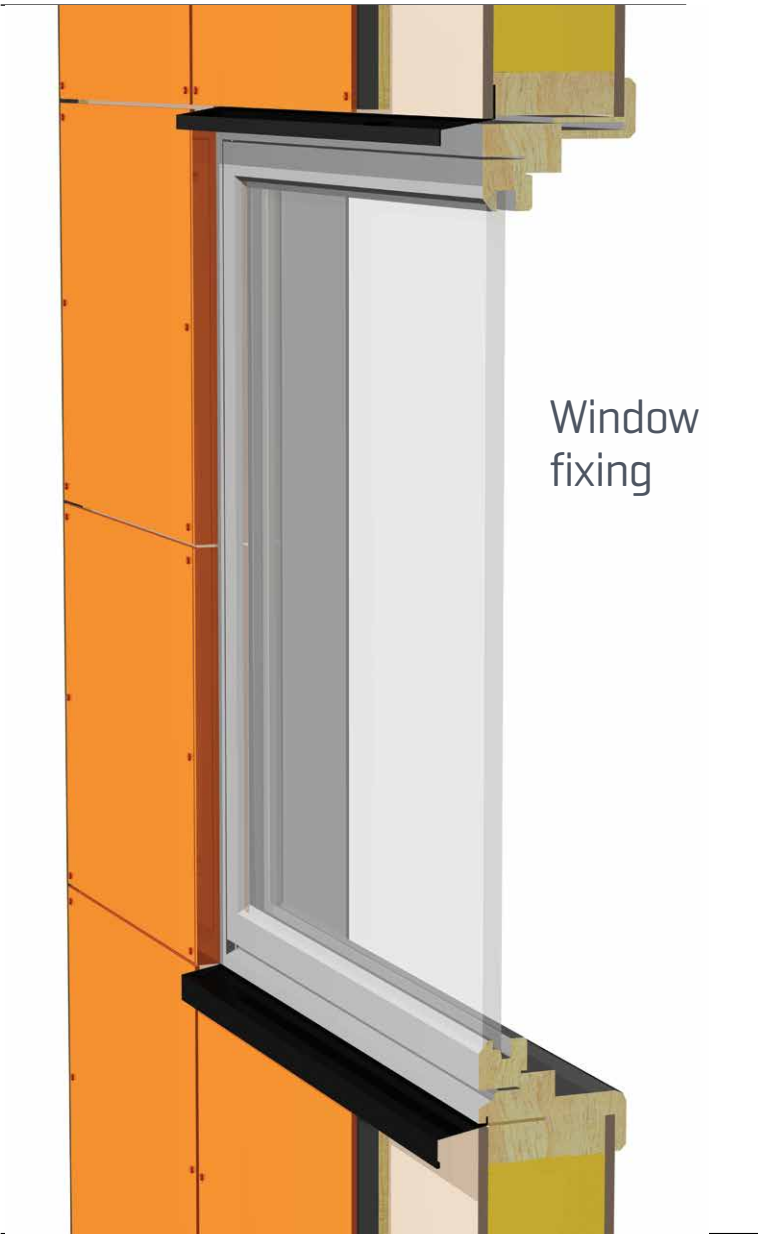

Window fixing

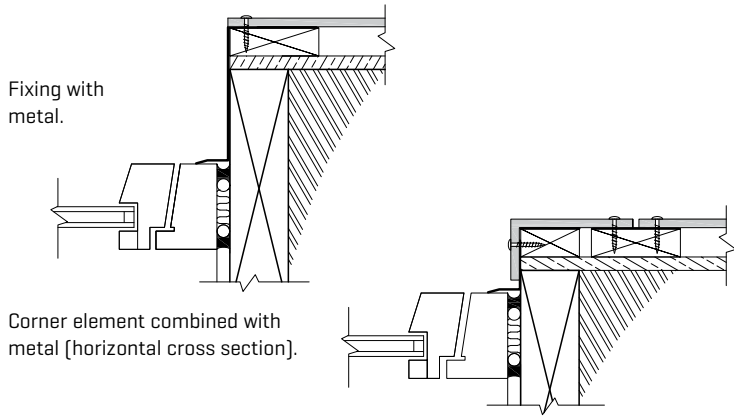

Fixing with metal.

Corner element combined with metal (horizontal cross section).

STENI facade panels fixed as ventilated cladding

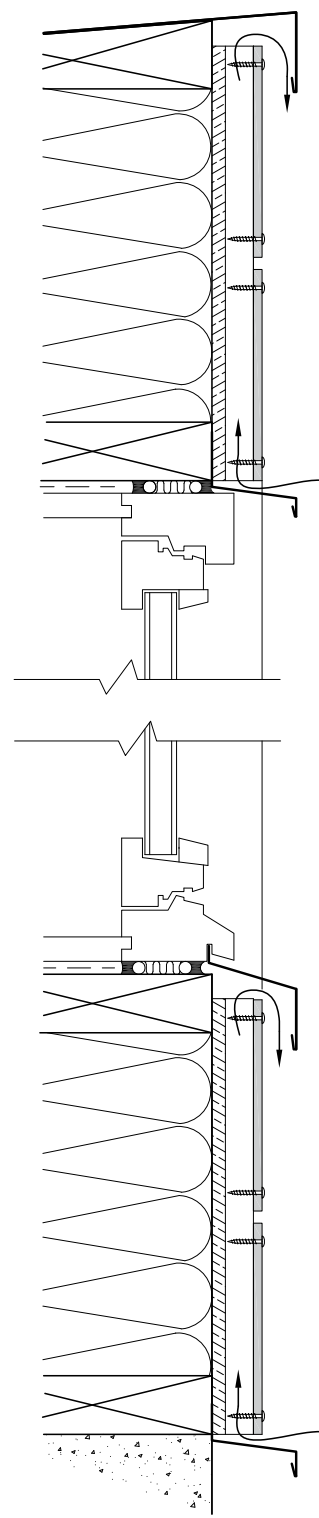

Steni-203-UK-01.16